

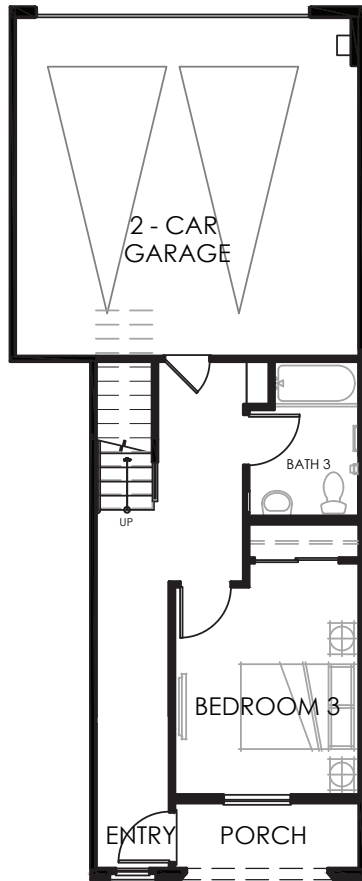

PLAN 4 HC, The Ponderosa
3 Bed, 3.5 Bath
2-Car Side-by-Side Garage
Approx. 1,743 Sq Ft

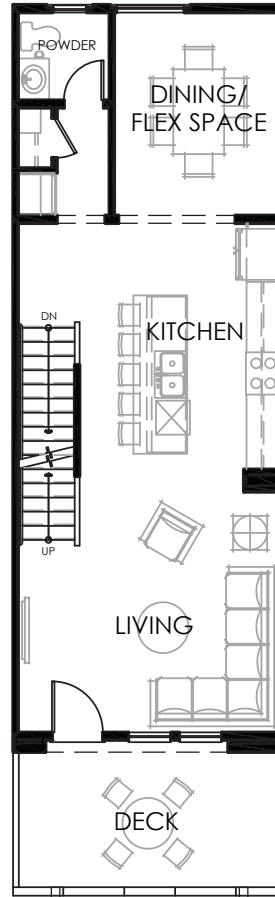

FIRST FLOOR



SECOND FLOOR

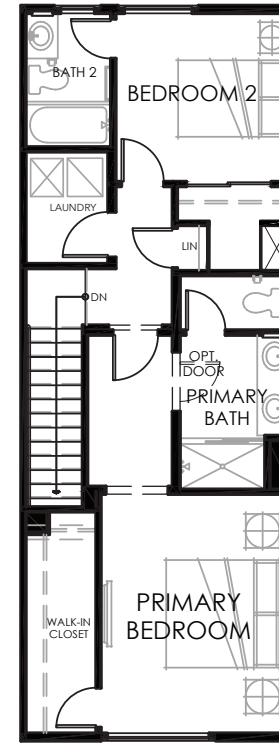

THIRD FLOOR

Azalea Walk by The Olson Company | 1335 W. 141st Street, Gardena, CA 90247 | (562) 370-9518 | azalea@theolsonco.com | AzaleaWalk.com

Floorplans and renderings are artist's conception based on preliminary information. Some homesites may be pre-plotted for specific variations or options. Please consult your Home Advisor for details. In an effort to improve our homes, Olson Homes reserves the right to change features, prices or plans without notice. Windows, doors, porches, patios and decks vary per elevation and per homesite location. Floorplan measurements are approximate. Prices and availability are subject to change without notice. BRE #01877641. CSLB #939166 Olson Urban Housing, L.P.